

Addendum Number 2
Laramie County Community College
South Irrigation System Rehabilitation
December 21, 2016

Addendum Number 2 applies to the above listed project.

- I. Contract Irrigation Plans to be added to the construction plan set. Irrigation Plan set notation is for Addendum No. 1 but is inclusive solely with Addendum No. 2 which was issued on the same date.

Kelly W. Hafner

Kelly W. Hafner, P.E.
BenchMark Engineers, P.C.

Encl: **A) Irrigation Plan Sheets (2)**
 1) Irrigation Plan I-1 (dated 12/22/16)
 2) Irrigation Details I-2 (dated 12/22/16)

Note: All bidders must acknowledge receipt of this addendum with the submittal of their bid.

END OF ADDENDUM 2

Irrigation Equipment and Materials Schedule					
SYMBOL	MANUFACTURER	MODEL NO.	DESCRIPTION	DETAIL NO.	COMMENTS
●	RAIN BIRD	1806-SAM-PRS W/ NP-CAP & NOZZ.	POP-UP SPRAY HEAD	1	PURPLE CAP
● 250 ● 25H	RAIN BIRD	I-20-06-R W/ 25MPR SERIES NOZZ.	GEAR DRIVEN ROTOR	2	PURPLE CAP
○	RELIABLE CONTROLS	-	ELECTRIC CONTROLLER		
○	RAIN BIRD	44 NP	QUICK COUPLING VALVE	4	
○	IRRITROL	700 ULTRAFLOW SERIES	ELECTRIC CONTROL VALVE	3	
—		LINE SIZE	DRIP LINE BLOW-OUT STUB	5	
—		SCHEDULE 40 SOLVENT WELD	PVC SLEEVING		
—		SCHEDULE 40 SOLVENT WELD - 1" DIA. UNLESS NOTED OTHERWISE	PVC LATERAL	8	
—		SCHEDULE 40 SOLVENT WELD	PVC MAINLINE	8	
—	CENTENNIAL	3/4" I.D.	POLY DRIP TUBING	7	
—	RAIN BIRD	1"	DRIP VALVE ASSEMBLY	6	
—			NEW IRRIGATION WIRING	8	
CONTROLLER & STATION NO. CONTROL VALVE SIZE					

Irrigation Construction Notes

- ALL BASE INFORMATION HAS BEEN TAKEN FROM DRAWINGS PREPARED BY LIME GREEN DESIGN.
 - REFER TO TECHNICAL SPECIFICATIONS AND CONSTRUCTION DETAILS FOR INSTALLATION PROCEDURES.
 - CONTRACTOR SHALL FIELD VERIFY PRESSURE AT BACKFLOW PREVENTER LOCATION FOR EACH TAP PRIOR TO ORDERING MATERIALS OR STARTING ANY IRRIGATION INSTALLATION AND NOTIFY CONSULTANT OF ANY DIFFERENCES FROM STATED PRESSURE. IF CONTRACTOR FAILS TO NOTIFY CONSULTANT HE ASSUMES FULL RESPONSIBILITY FOR ANY SYSTEM ALTERATIONS. EACH SYSTEM HAS BEEN DESIGNED FOR A DYNAMIC PRESSURE OF 65 PSI.
- | TAP LOCATION/NUMBER | REQUIRED PRESSURE |
|---------------------|-------------------|
| 1 | 52 PSI |
- REFER TO PLANTING PLAN FOR EXACT TREE LOCATIONS AND QUANTITIES, TREES SHOWN ON IRRIGATION PLANS ARE APPROXIMATE.
 - CONTRACTOR SHALL REPAIR OR REPLACE ANY EXISTING IRRIGATION EQUIPMENT, TURF, PLANT MATERIAL OR SITE FEATURES DAMAGED DURING NEW INSTALLATION. REPLACEMENT OR REPAIR OF DAMAGED EQUIPMENT OR MATERIAL SHALL BE DETERMINED BY THE OWNER AND THE CONSULTANT.
 - VALVE BOXES SHALL BE LOCATED 36" MINIMUM FROM CENTERLINE OF ALL SWALES, 24" MINIMUM FROM EDGES OF ALL WALKS, CURBS, DRIVES AND OTHER HARD SURFACE AREAS.
 - REFER TO IRRIGATION TECHNICAL SPECIFICATIONS FOR PLANTING AND IRRIGATION LAY-OUT REQUIREMENTS, COORDINATION AND PRIORITIES.
 - LATERAL PIPING DIAMETERS SHALL INCLUDE 1", 3/4" DIAMETER LATERAL PIPE IS NOT ACCEPTABLE.
 - IRRIGATION SYSTEMS HAVE BEEN DESIGNED TO BE ANNUALLY WINTERIZED UTILIZING COMPRESSED AIR.
 - CONTRACTOR IS RESPONSIBLE TO WINTERIZE THE IRRIGATION SYSTEM IN THE FALL OF THE YEAR IN WHICH THE IRRIGATION & LANDSCAPE WAS ACCEPTED. CONTRACTOR SHALL ALSO PERFORM SYSTEM START-UP IN APRIL OF THE FOLLOWING SPRING.
 - ALL IRRIGATION WIRE SHALL BE #14 AWG UFUL WIRE WITH SINGLE, SOLID COPPER CONDUCTOR AND POLYETHYLENE INSULATION (MULTI-CONDUCTOR WIRE IS NOT ACCEPTABLE). WIRE COLORS SHALL BE: CONTROL WIRES - RED, COMMON WIRE - WHITE, SPARE WIRES - BLACK, WATERTIGHT WIRE SPLICES SHALL BE MADE WITH 3M CO. DBRY-6 SPLICE KITS.
 - ALL VALVE BOXES SHALL BE MANUFACTURED BY CARSON INDUSTRIES. MODELS SHALL BE AS FOLLOWS:
#919-10: QUICK COUPLING VALVES, DRIP LINE BLOW-OUT STUBS, GATE VALVES, DRAIN VALVES.
#1419-12: ELECTRIC CONTROL VALVES, DRIP VALVE ASSEMBLY, MASTER VALVE. BOXES AND LIDS SHALL BE GREEN.
 - CONTRACTOR SHALL WARRANTY ALL WORK (MATERIALS, EQUIPMENT AND WORKMANSHIP) FOR A ONE YEAR PERIOD FOLLOWING FINAL ACCEPTANCE OF LANDSCAPE AND IRRIGATION BY OWNER.

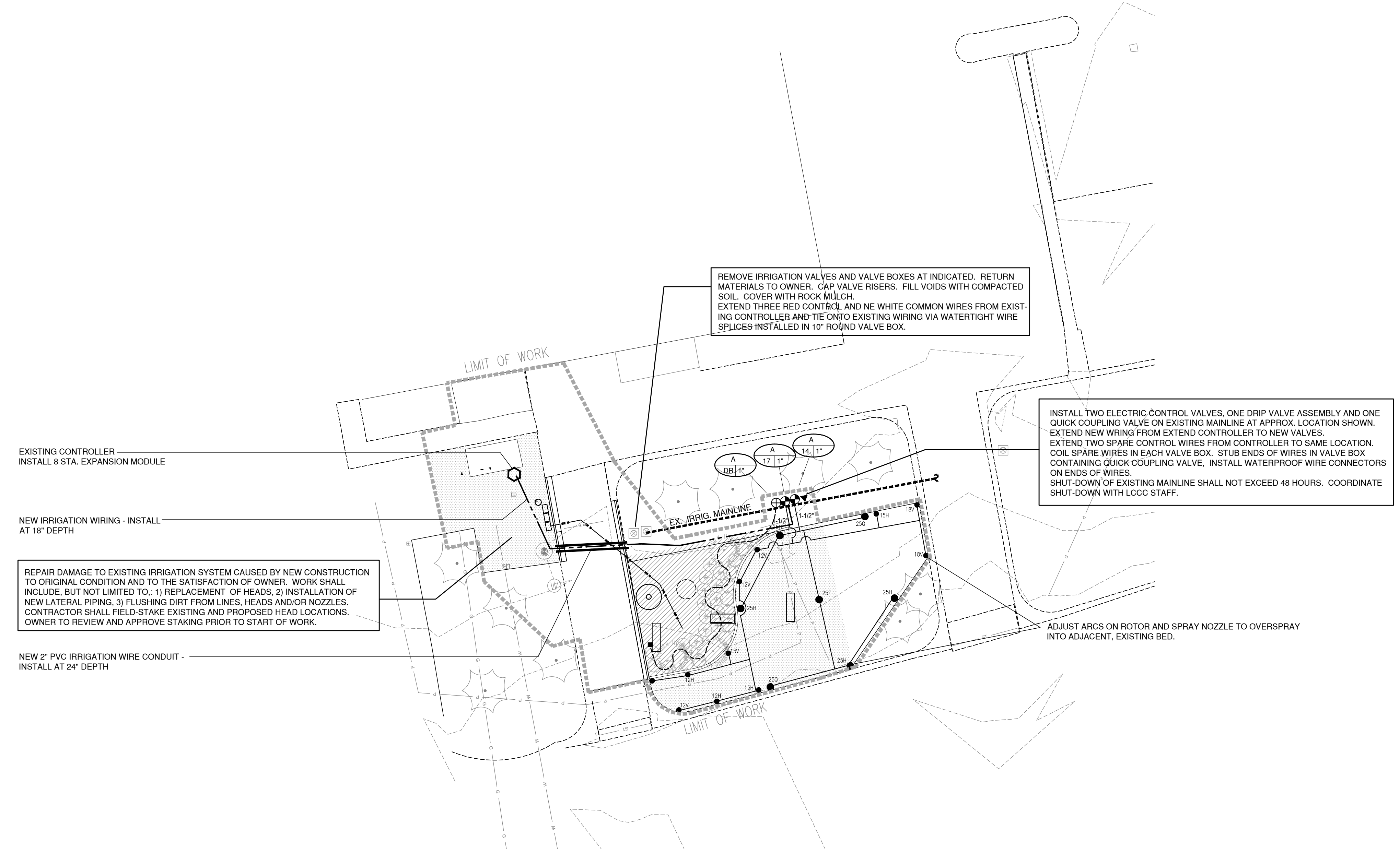

Notes & Revisions:
ADDENDUM NO. 1 - 12-22-16

Plan Set
A 12/15/16
Plan Set
Plan Set
Plan Set
Plan Set

MACY ENGINEERING, P.C.
MECHANICAL ENGINEERING CONSULTING
218 WEST 18TH ST. CHEYENNE, WYOMING 82001
(307) 831-4049

Lime Green Design, Inc.
509 E. Colfax Ave. Suite 205
Denver, Colorado 80202
P 303.733.7558

Benchmark ENGINEERS PC
1920 Thomas Avenue, Suite 620
Cheyenne, Wyoming 82001
P 307.773.0100
benchmarkengineers.com

BIME

LARAMIE COUNTY COMMUNITY COLLEGE
SOUTH IRRIGATION SYSTEM REHABILITATION

LARAMIE COUNTY WYOMING

Project No.
Design By:
Check By:
Drawn By:
File:

Sheet No.
IRRIGATION PLAN
1-1

Avocd IRRIGATION DESIGN
7114 W. JEFFERSON AVENUE, SUITE 201
LAKEWOOD, COLORADO 80235
VOICE: 303.989.2175
FAX: 303.989.5814

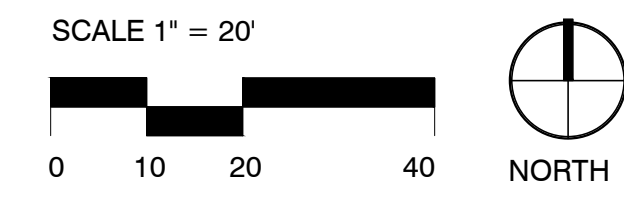

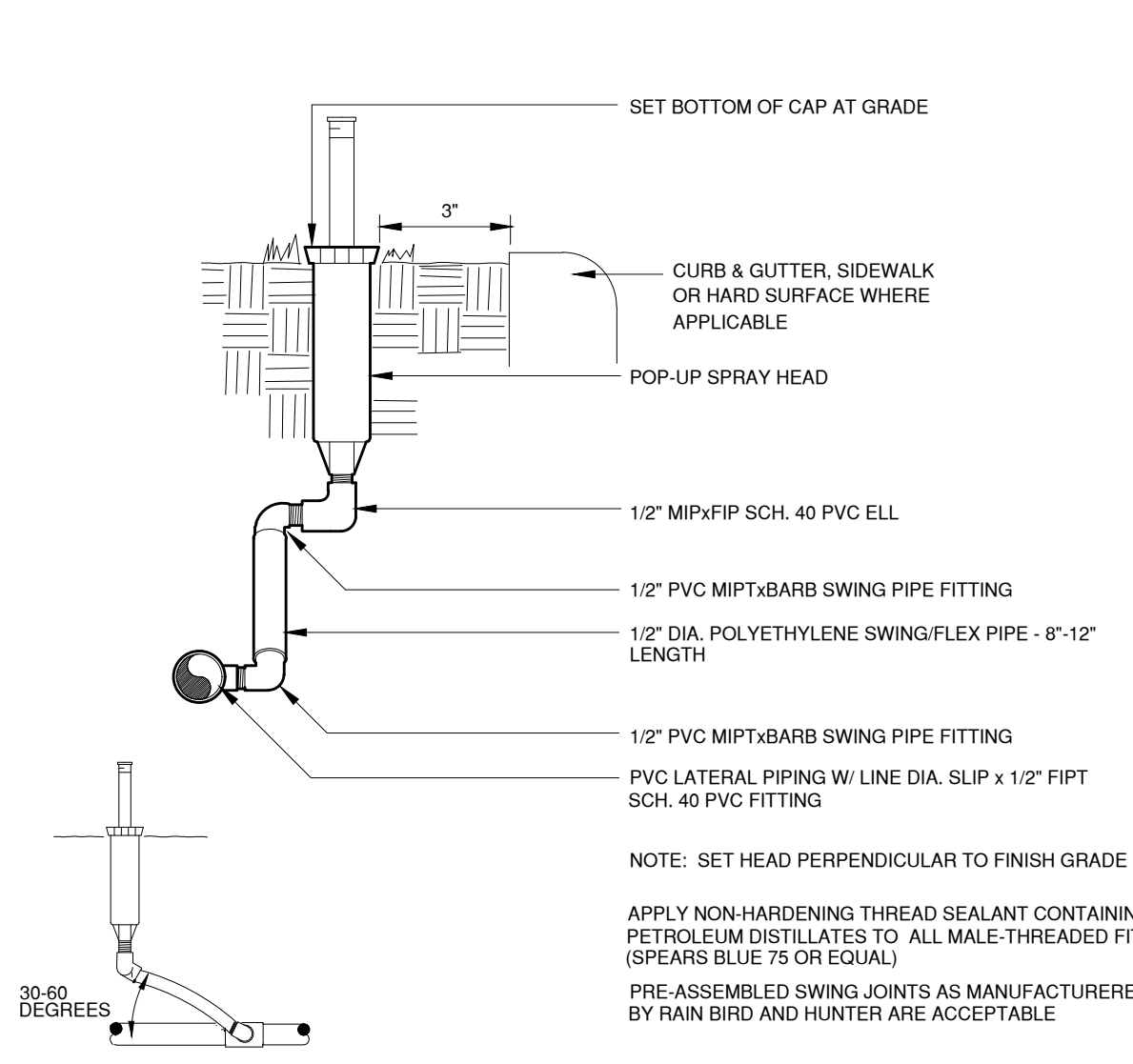

POP-UP SPRAY HEAD 1

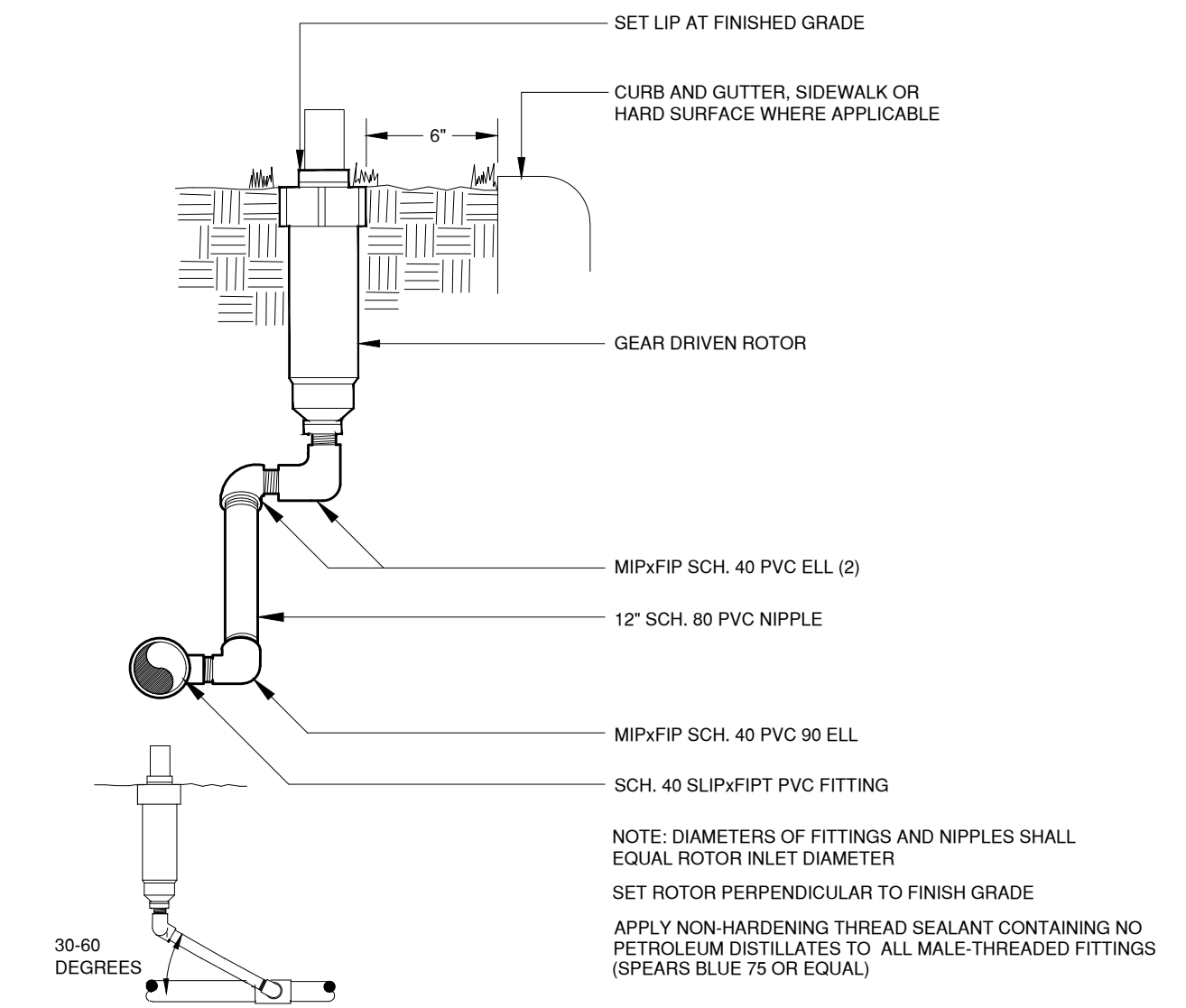

GEAR DRIVEN ROTOR 2

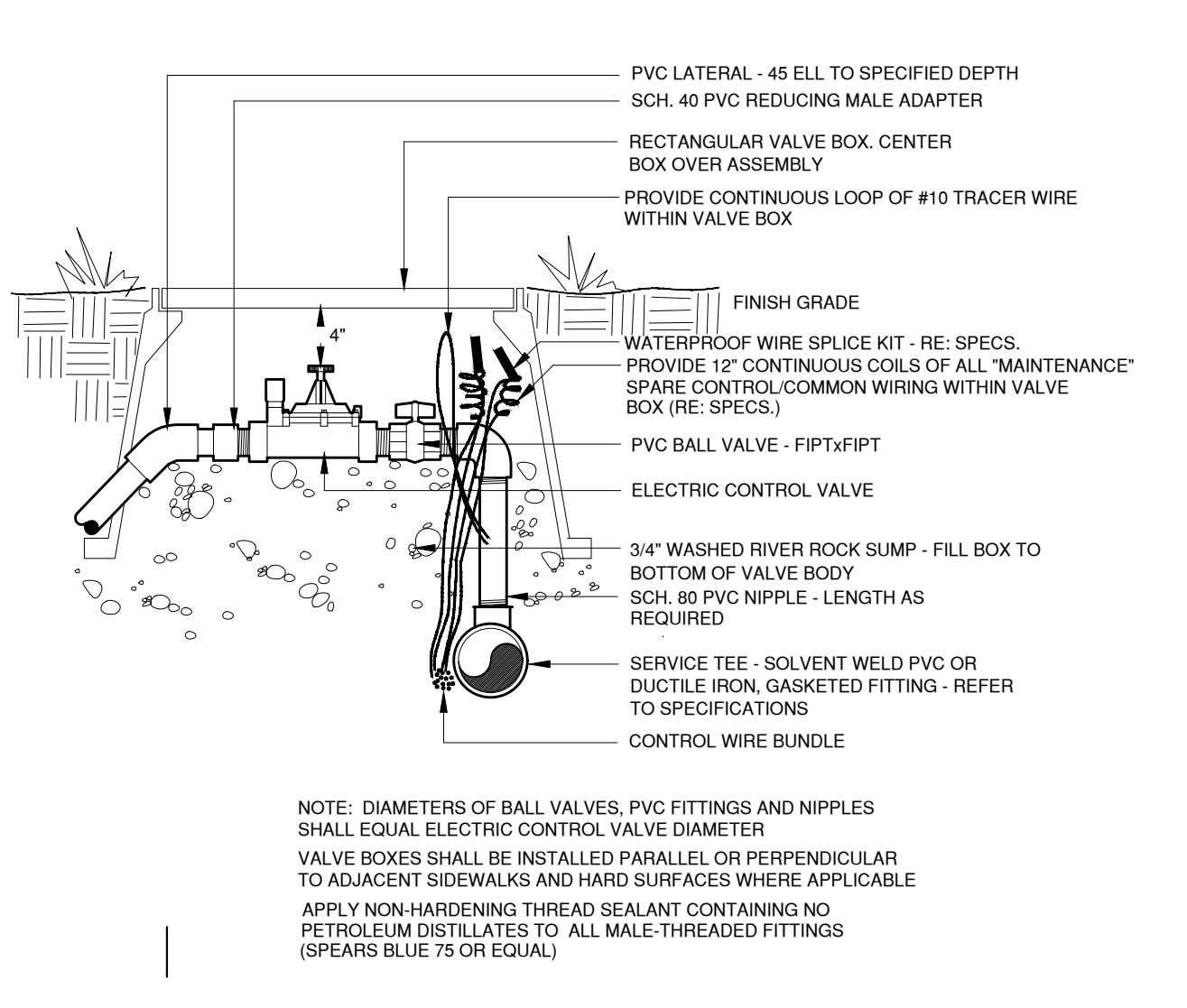

ELECTRIC CONTROL VALVE 3

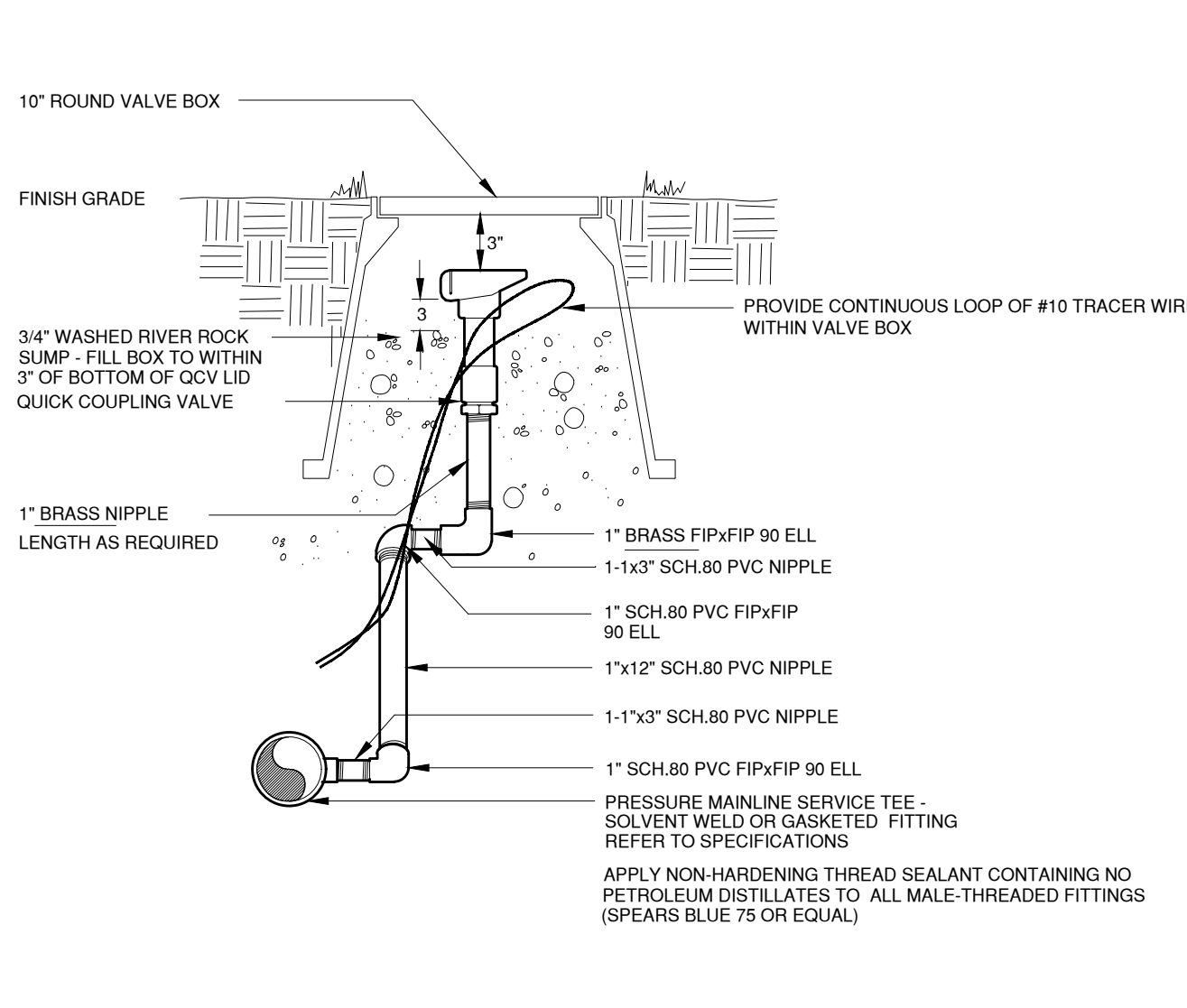

QUICK COUPLING VALVE 4

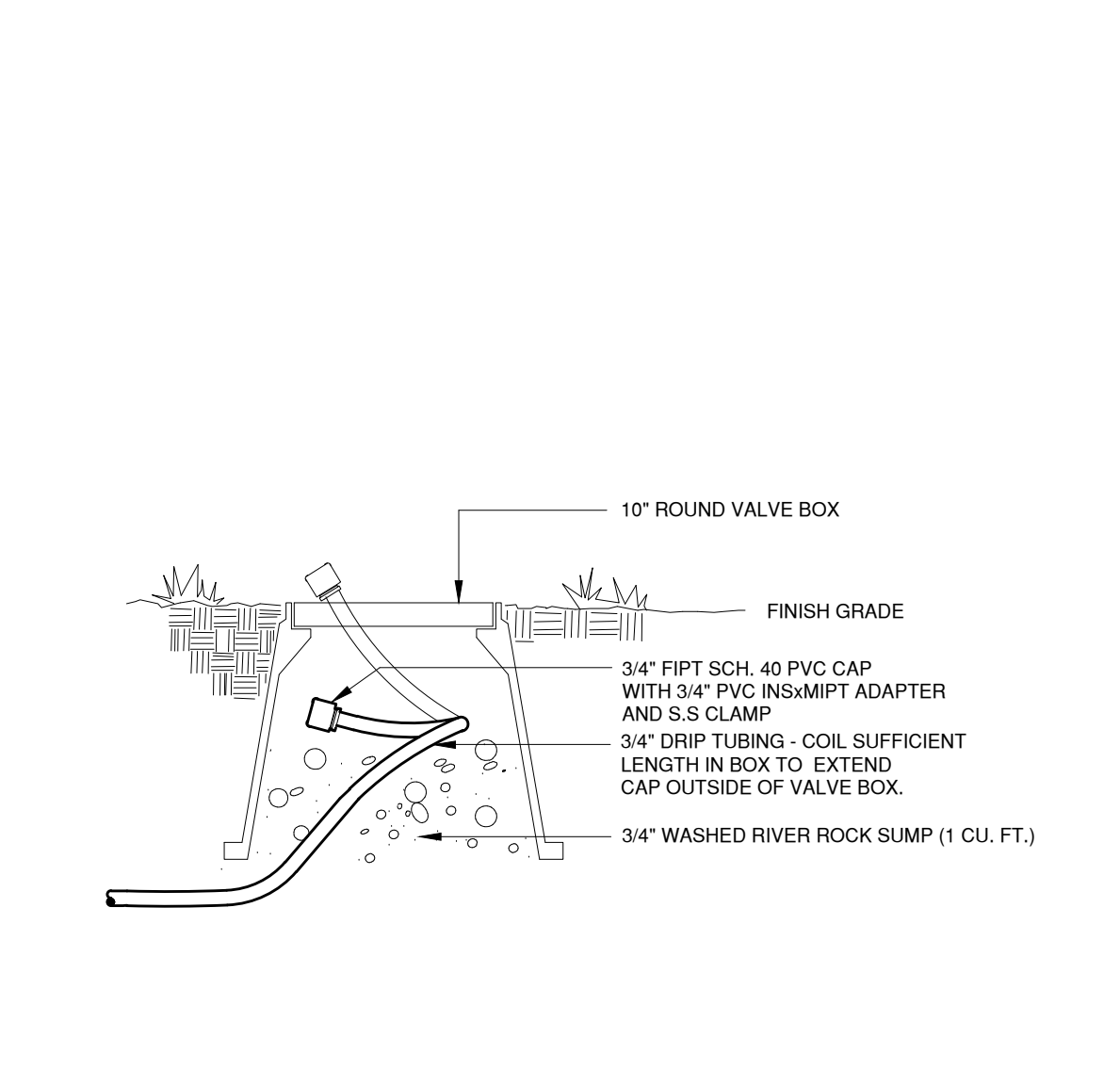

DRIP LINE BLOW-OUT STUB 5

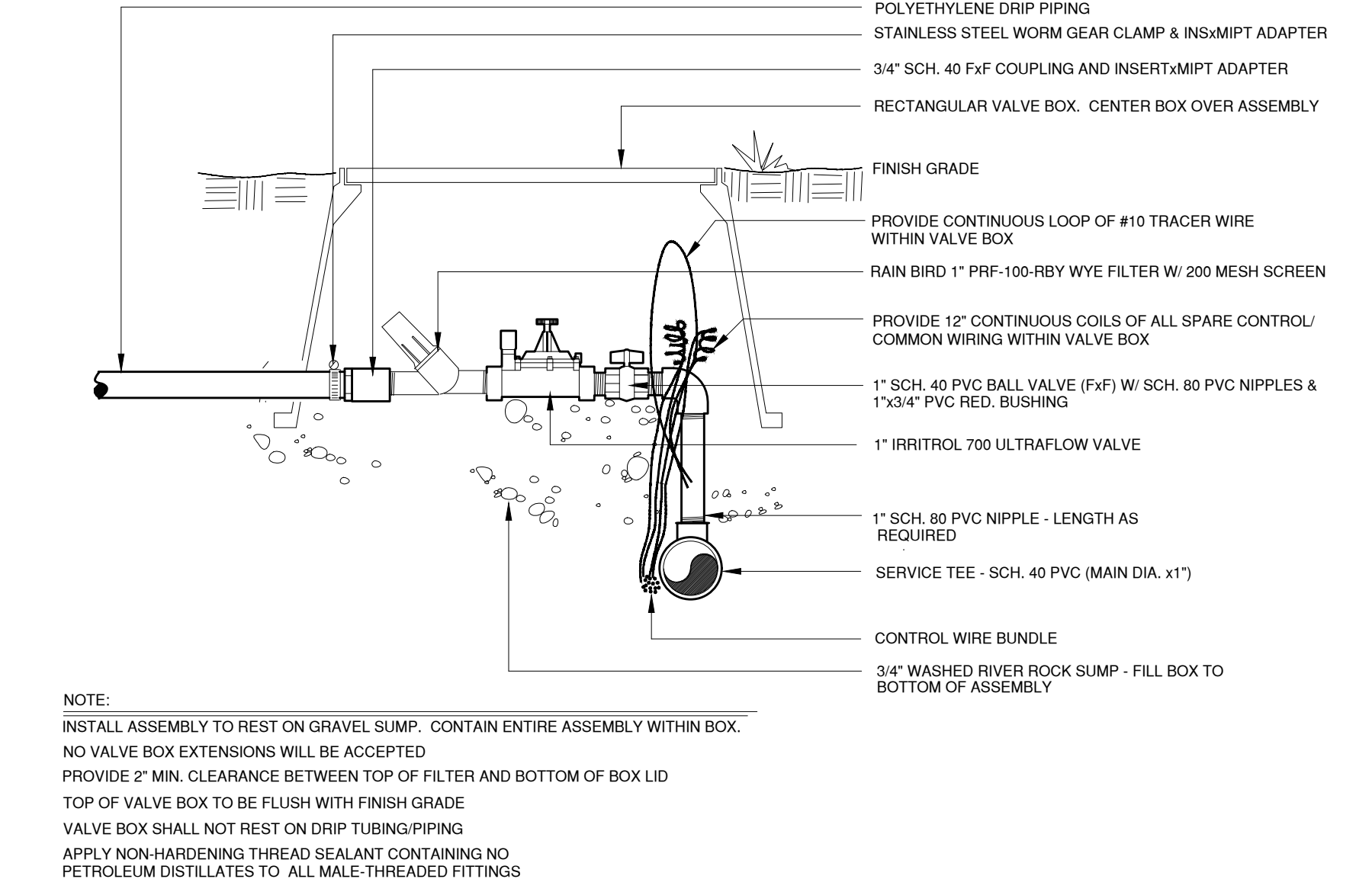

DRIP VALVE ASSEMBLY 6

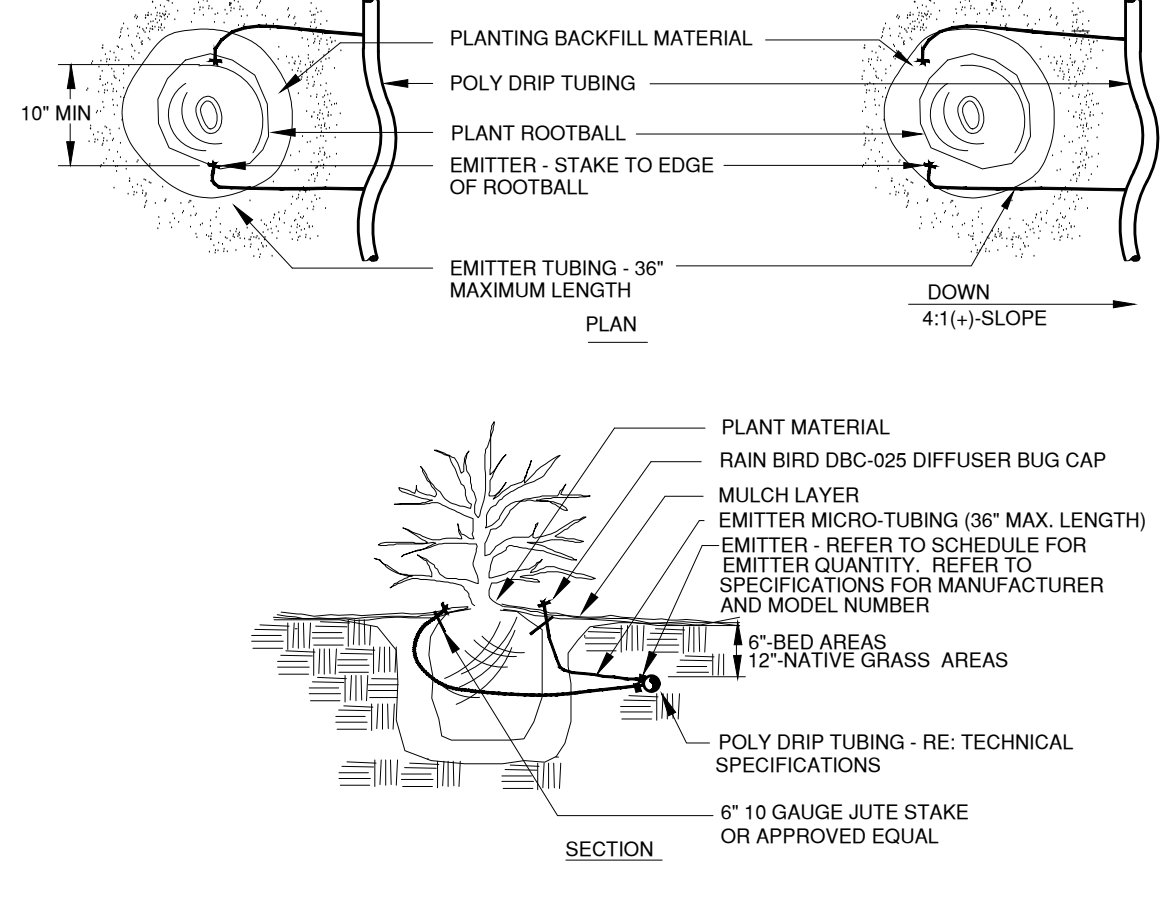

DRIP EMITTER 7

PLANT SIZE	EMITTER FLOW RATE	EMITTER QTY. AT MULCHED BED LOCATIONS
1 GALLON MATERIAL	0.5 GPH	ONE EACH
5 GALLON MATERIAL	0.5 GPH	TWO EACH
1 1/2" CALIPER TREE	1.0 GPH	THREE EACH
2" CALIPER TREE	1.0 GPH	FOUR EACH
2 1/2" CALIPER TREE	1.0 GPH	SIX EACH
3" CALIPER TREE	1.0 GPH	EIGHT EACH
3 1/2" CALIPER TREE	1.0 GPH	NINE EACH
4" CALIPER TREE	1.0 GPH	TEN EACH
6 FT. CONIFEROUS TREE	1.0 GPH	FOUR EACH
8 FT. CONIFEROUS TREE	1.0 GPH	SIX EACH
10 FT. CONIFEROUS TREE	1.0 GPH	EIGHT EACH
12 FT. CONIFEROUS TREE	1.0 GPH	TEN EACH

NOTES:
 INSTALL EMITTERS ON OPPOSING SIDES OF ROOTBALL. THREE OR MORE EMITTERS SHALL BE EQUALLY SPACED AROUND ROOT BALL.
 EMITTERS ARE TO BE INSTALLED TO CLEAR SURFACE BY A MINIMUM OF 1" AND A MAXIMUM OF 2".
 FLUSH ALL LINES THOROUGHLY, INCLUDING EMITTER MICRO-TUBING PRIOR TO EMITTER INSTALLATION.
 IF PLANTING ON A 4:1 SLOPE OR STEEPER, INSTALL BOTH EMITTERS ON UPHILL SIDE OF ROOT BALL.
 EMITTERS SHALL BE SELF-FLUSHING, PRESSURE COMPENSATING-TYPE UNLESS NOTED OTHERWISE WITHIN TECHNICAL SPECIFICATIONS.

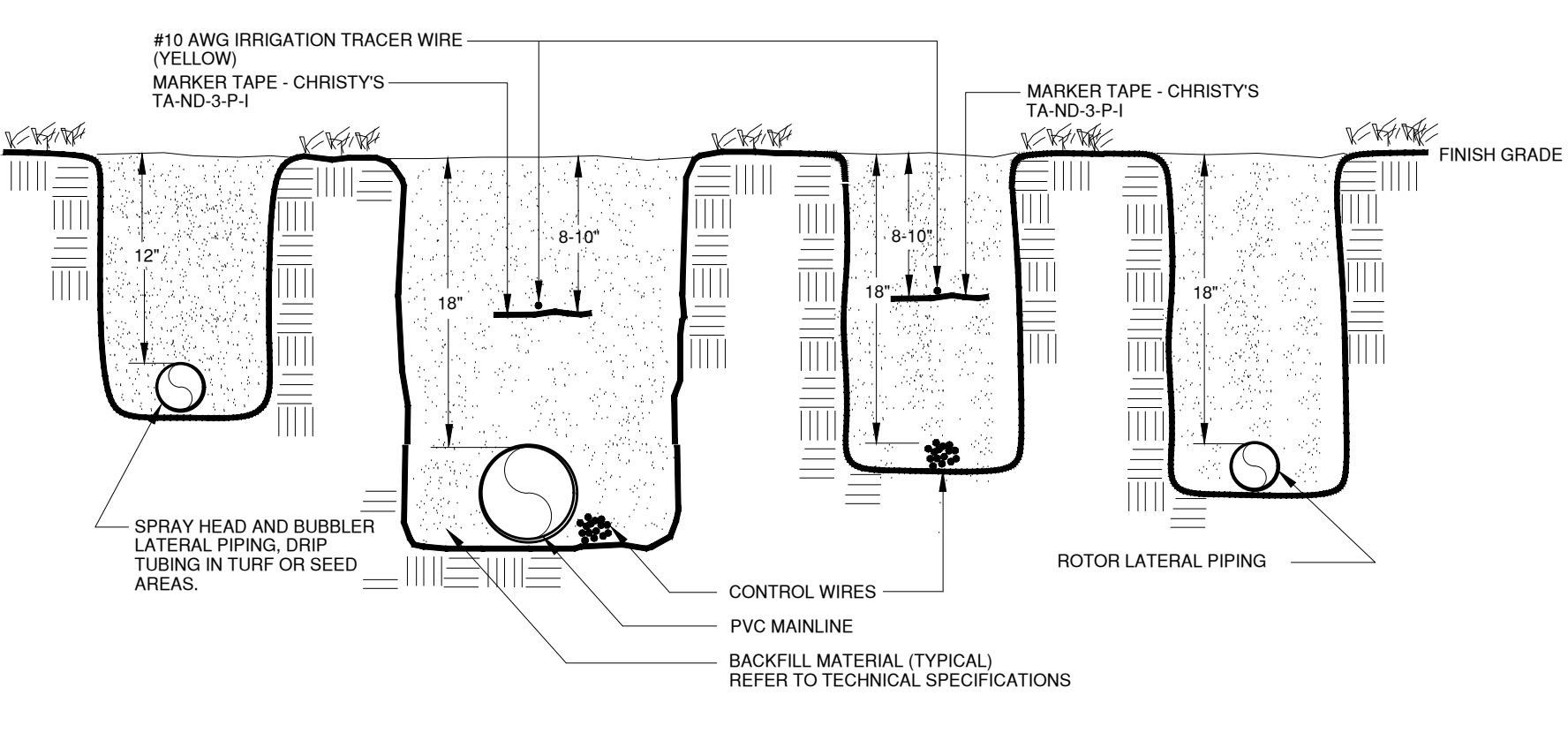

TRENCHES 8

Notes & Revisions:
 ADDENDUM NO. 1 - 12-22-16

Plan Set A 12/15/16

Plan Set

Plan Set

Plan Set

Plan Set

Plan Set

MACY ENGINEERING, P.C.
 MECHANICAL ENGINEERING CONSULTING
 218 WEST 18TH ST. CHEYENNE, WYOMING 82001
 (307) 831-4049

Lime Green Design, Inc.
 509 E. Collins Ave. Suite 205
 Denver, Colorado 80210
 P. 303.733.7558

Benchmark ENGINEERS PC
 1920 Thomas Avenue, Suite 620
 Cheyenne, Wyoming 82001
 P. 307.273.0100
 benchmarkengr.com

BME

LARAMIE COUNTY COMMUNITY COLLEGE
 SOUTH IRRIGATION SYSTEM REHABILITATION

LARAMIE COUNTY WYOMING

Project No.

Design By:

Check By:

Drawn By:

File:

Sheet No.

1-2